

45 Bartlett Street  
Marlborough, MA 01752  
(P)508-481-9200  
(F)508-481-9261  
www.axcelphotonics.com

T21\_WHP2\_04b TO 9mm P-down

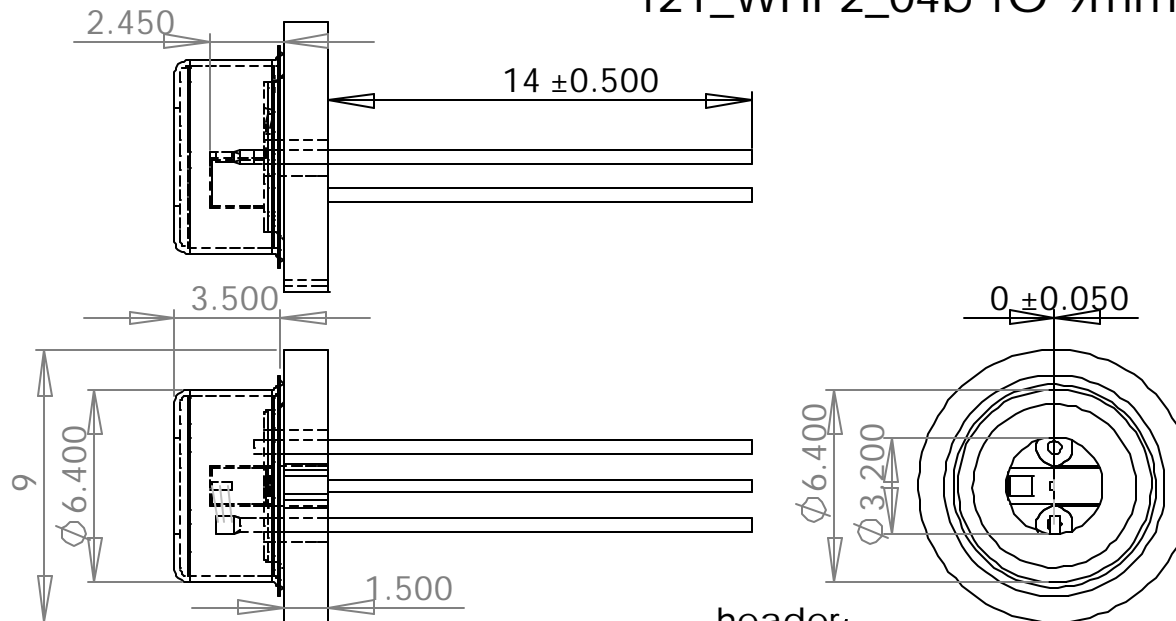
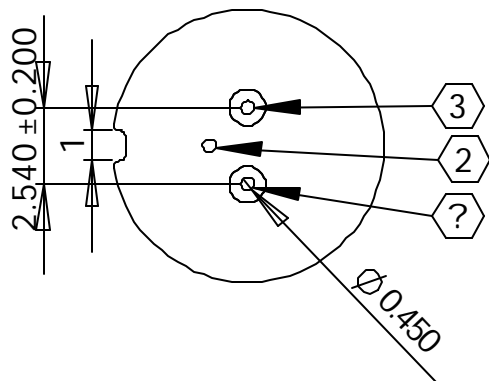

NOTES:

1 UNIT: mm

2 CHIP REFERENCE

DIMENSION:

750um x 300um x 150 um

3 From 9 mm center to PD edge:

0.75 mm +/- 0.05 mm

Pinout:

1 LD Cathode(-)

2 LD Anode(+)

2 PD Cathode (optional)

3 PD Anode (optional)

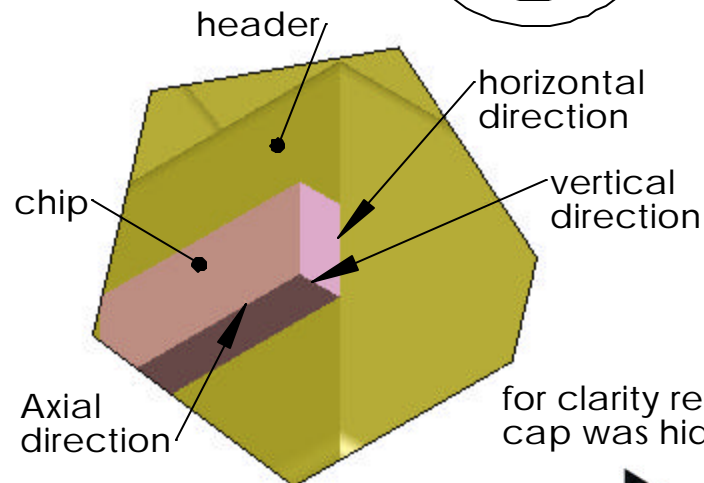
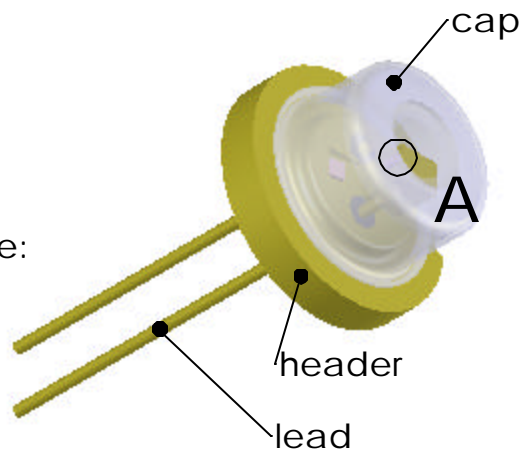

DETAIL A  
SCALE 50 : 1

THIS DRAWING IS THE PROPERTY OF AXCEL PHOTONICS. IT IS NOT TO BE COPIED, USED OR REPRODUCED WITHOUT PRIOR WRITTEN APPROVAL.

